

# Kettle's Yard house general

- You can sit down in the chairs.
  - There are a number of comfortable armchairs with armrests.
  - Lots of people find the house a very calming space.
  - You can chat to our Visitor Assistants throughout the house to find out more or ask for help.
  - Watch out – there are objects on open display that you need to be careful around.
  - Some of the doorways are quite narrow.
  - You can't take bags into the house but if you have a handheld comfort object please speak to a member of staff.
  - The spaces in the cottages are small with low ceilings and can get crowded. To avoid this, you can go through the quieter entrance near the café, please ask a member of staff.
  - There are exits on every floor if required – please ask a Visitor Assistant for help.
- 

 Spaces which may be crowded



Stairs



Door



Loud noises



Smells



Low ceilings



Lift



Access ramp



Low light



Loose rugs



Toilets

# Downstairs Cottages

Small spaces with low ceilings and low light

Can feel crowded with people and objects when busy

Narrow doorways

Smell of soot

Spiral staircase with floating stairs

Narrow stairwell

No handrail

Noisy doorbell

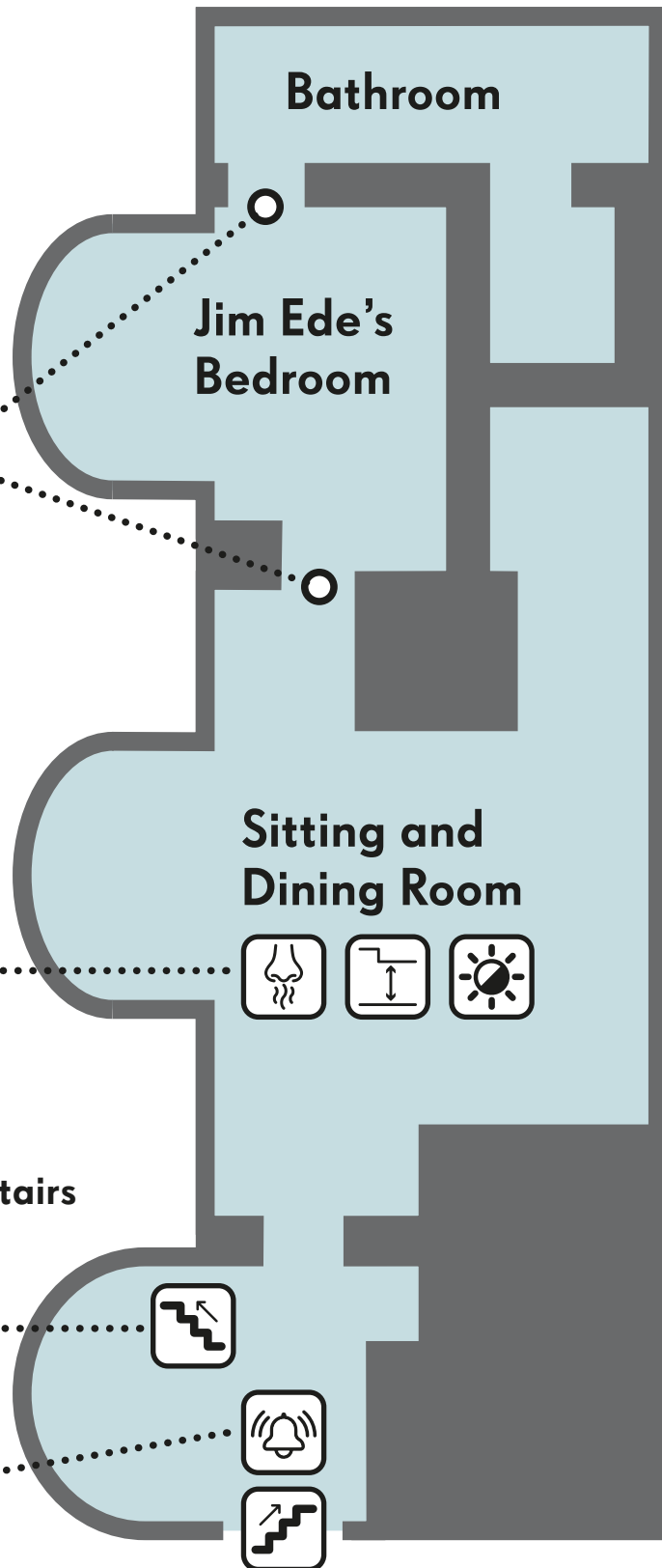

Entrance

Tickets, café and shop this way →

# Upstairs Cottages

## Bechstein Room and Helen Ede's Bedroom

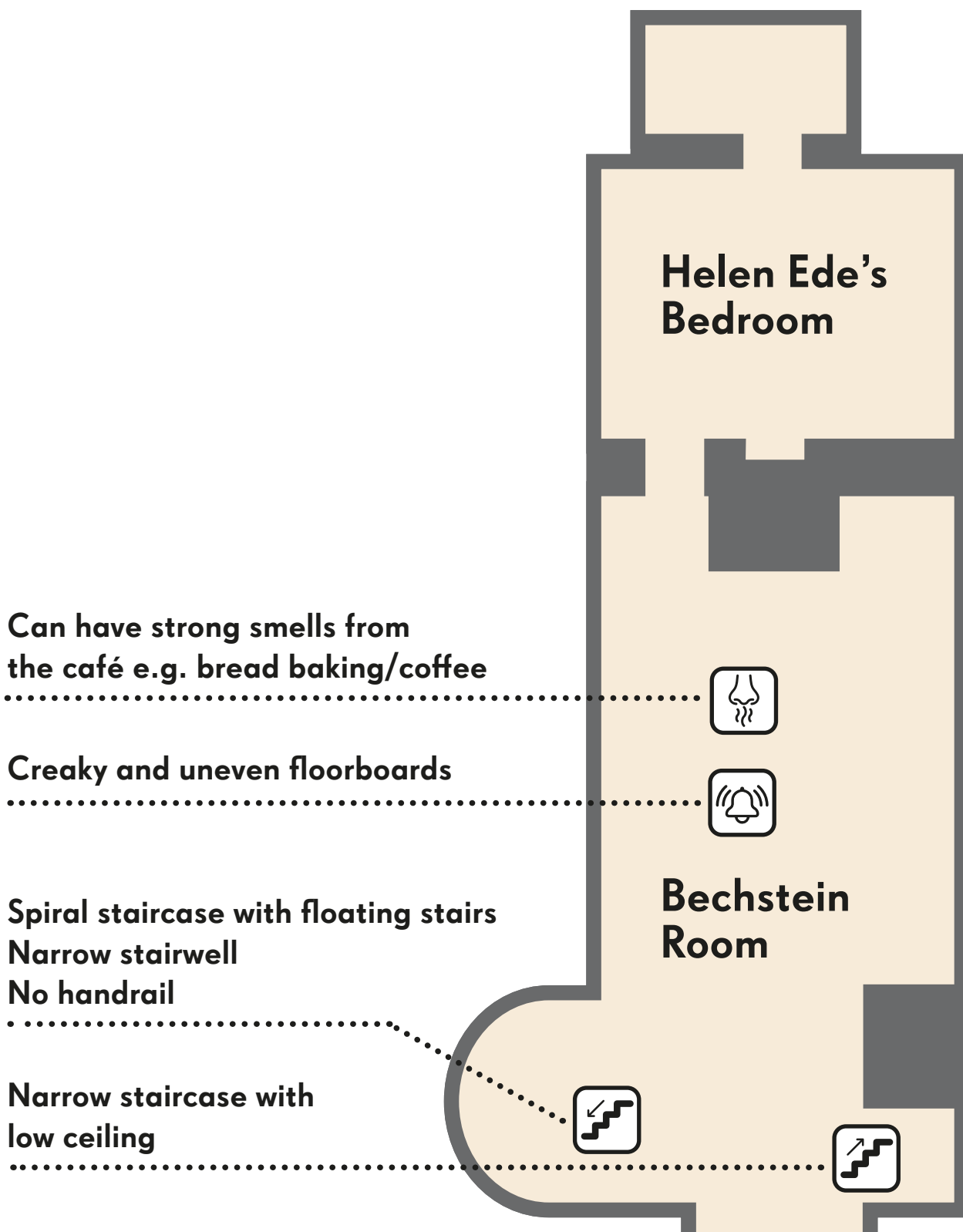

# Attic Cottages

Limited natural light,  
electric lighting



Exit by entry staircase  
Usually no Visitor Assistant on  
this floor



**Attic**

Creaky floorboards



Sloping walls/ceiling



Narrow steep staircase with  
low ceiling

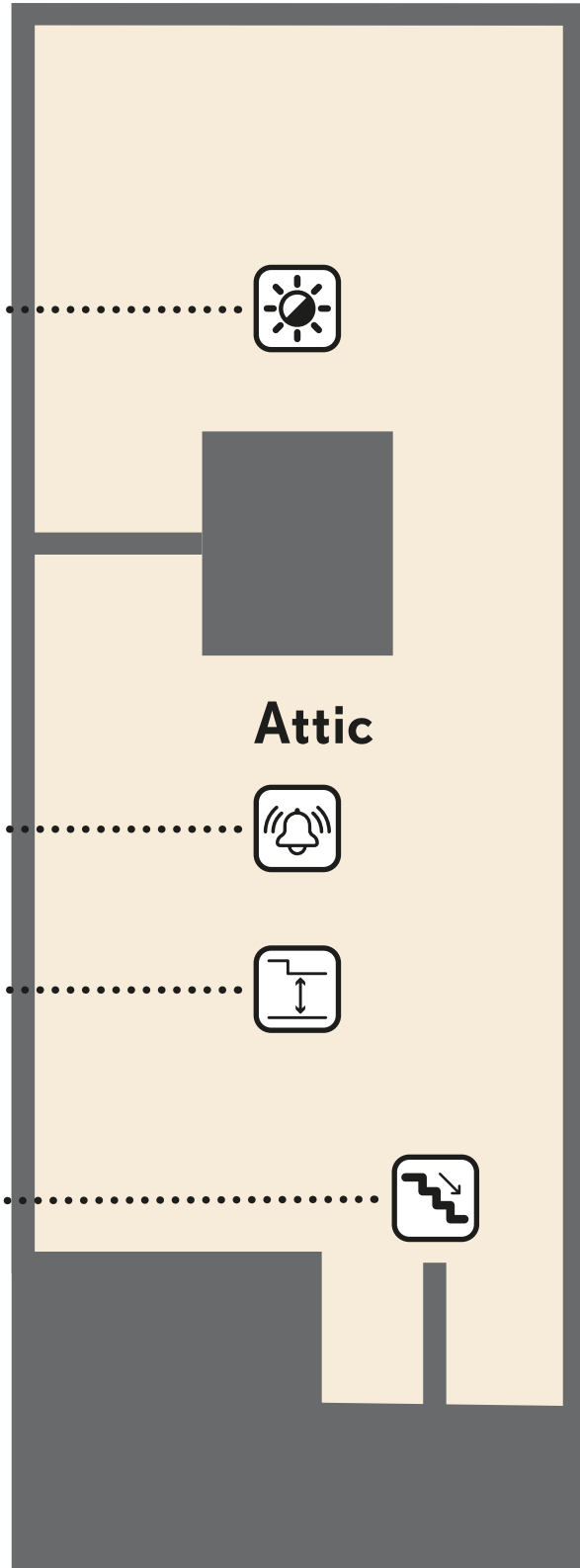

# Bridge, Dancer Room, First Floor Extension

Loose rugs throughout

You can read the books in the library

Void to double height space

Floating staircase with handrail

Wider, open space

Narrow space

Loose rugs

Sloping wall

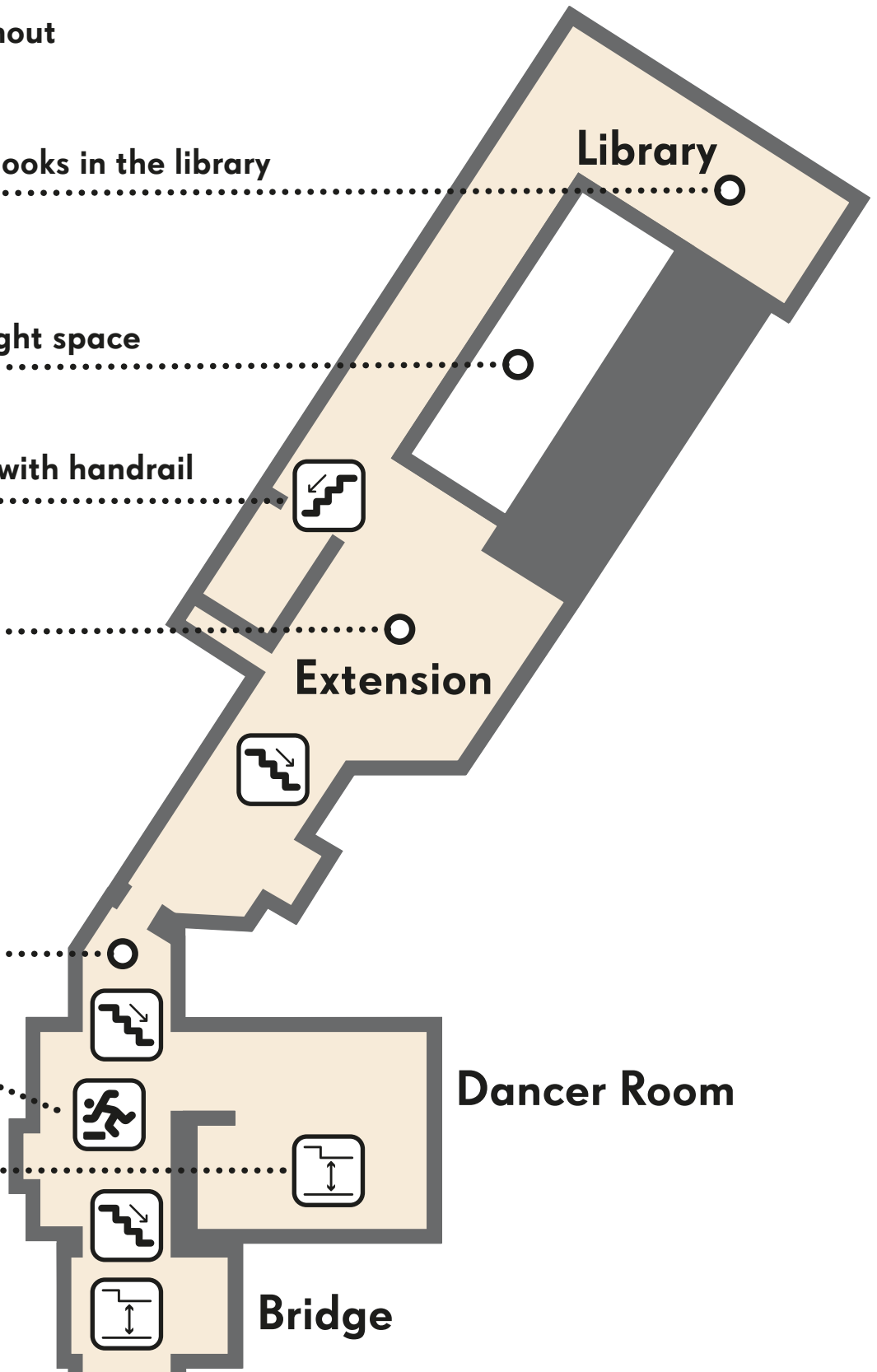

Library

Extension

Dancer Room

Bridge

# Downstairs Extension

Loose rugs throughout

Low sofa

Accesible ramp

Floating staircase  
with handrail

Exit

Wheelchair accessible entrance

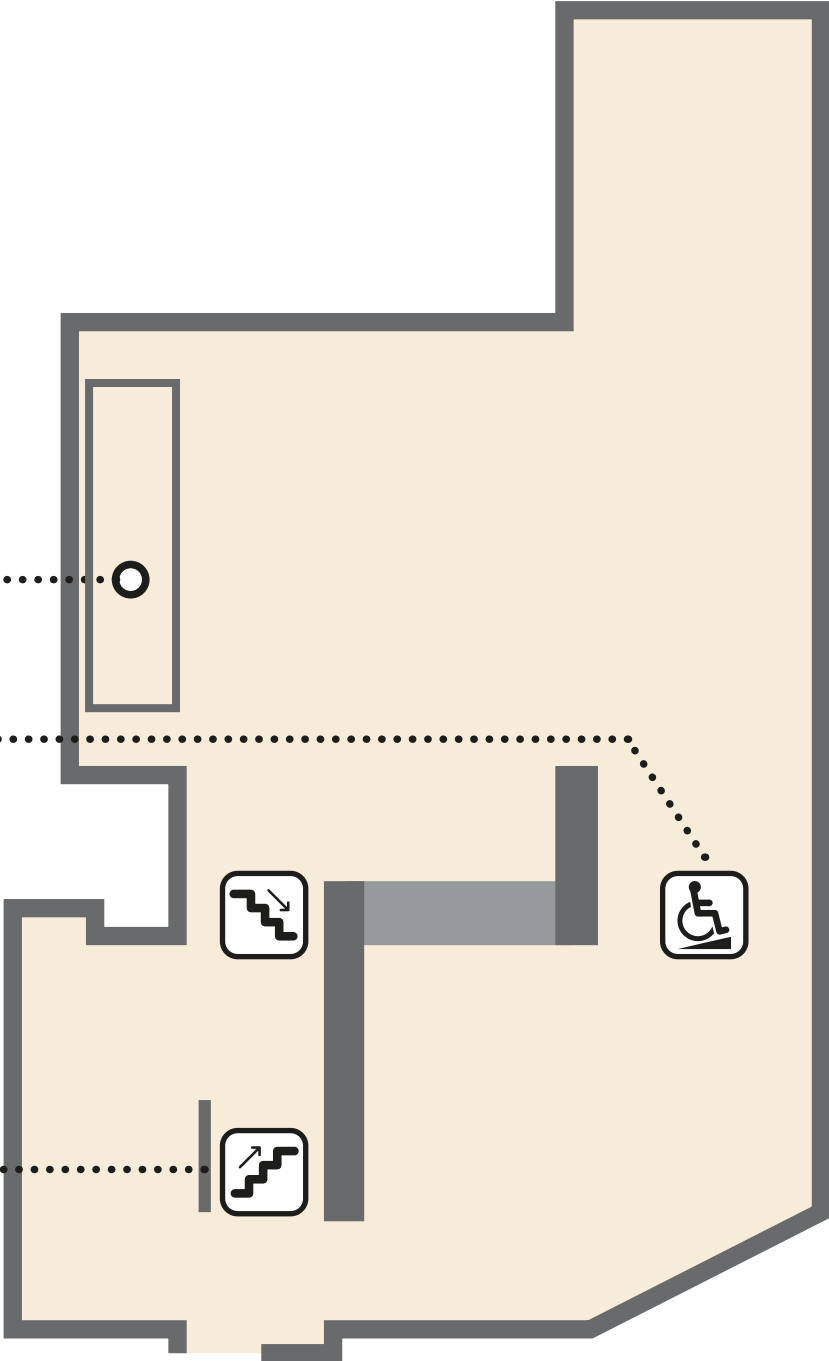

# Galleries, Shop, Café

**Café**  
Can be crowded and noisy  
(people talking, coffee machine)  
Bell for accessible ordering

**Shop**  
Narrow spaces  
Can be crowded

**Welcome area**  
Can be crowded and noisy  
You leave your bag here for house visits

**Galleries**  
Changing exhibitions  
please contact us for more details

**Wheelchair accessible toilet**  
Unisex toilets  
Paper towels in bathrooms  
(no hand-dryers)

**Outside Clore Learning Studio**  
Buggy parking

**Clore Learning Studio**  
Can be busy/crowded  
Relaxed, sensory-friendly sessions  
Wheelchair accessible toilet  
Baby change

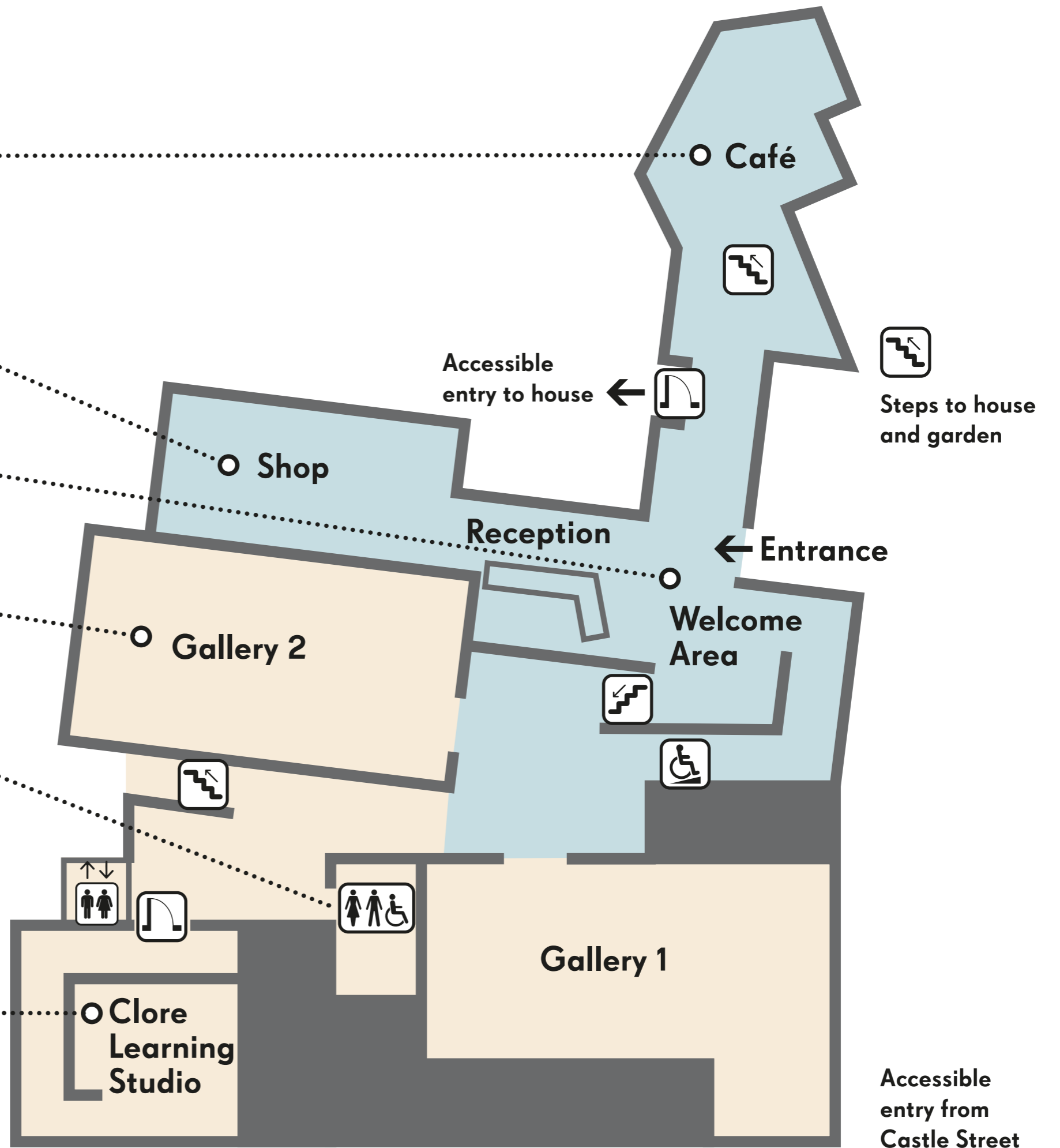

# Floor One

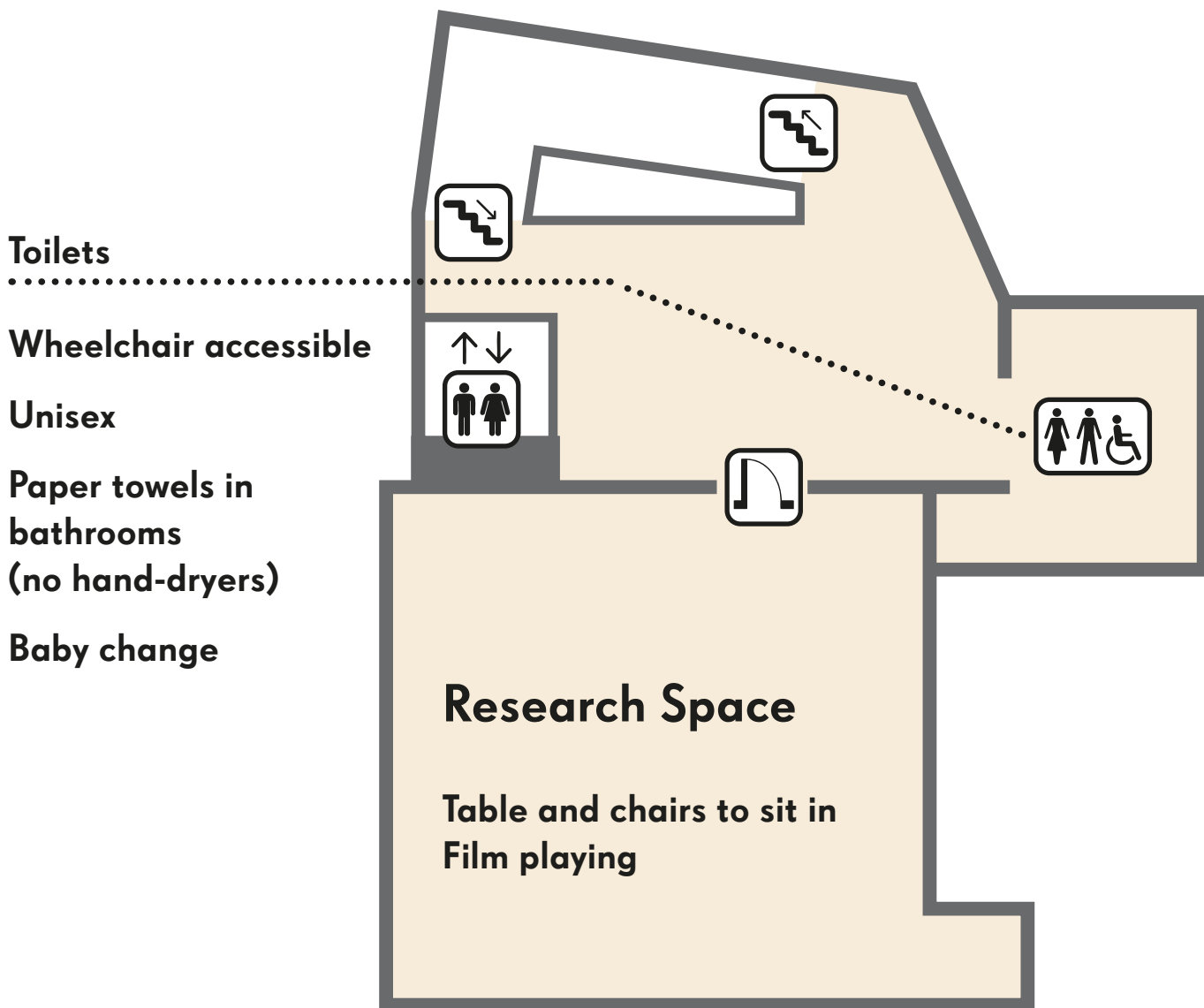



# Floor Two

**Reflect and Respond**

.....  
**Quiet space with table and bench for public use**

**Relaxed, sensory-friendly  
Studio Sunday sessions**

